



MOC Veranstaltungszentrum München

DETAILS ZUM KONFERENZRAUM K2

Flächen/Räume	Fläche in m ²	 Reihe	 Parlament	 Bankett
K2A	74	54	28	24
K2B	79	54	28	28
K2 ges.*	153	144	74	52

*Raum teilbar

Das MOC Veranstaltungszentrum München bietet Ihnen im Rahmen Ihrer Veranstaltung sechs Konferenzräume von 73 bis 377 m² für 50 bis 380 Personen. Unser Raumangebot passen wir flexibel an Ihre Anforderungen an.

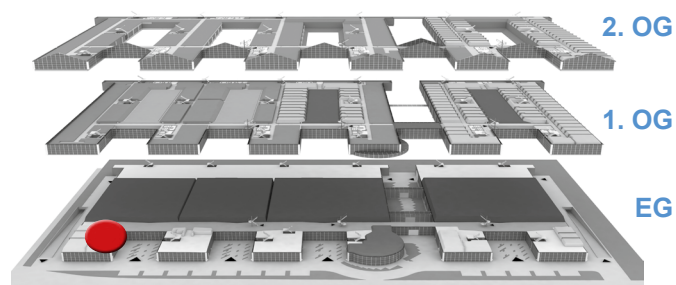

Technische Daten

Räume und Flächen	<ul style="list-style-type: none"> Wahlweise: K2A 74 m², K2B 79 m², K2 153 m²
Fußboden	<ul style="list-style-type: none"> Teppichboden
Raumhöhe	<ul style="list-style-type: none"> 3,85 m
Kommunikation	<ul style="list-style-type: none"> Telefon Telefax IP-Anschlüsse W-LAN für Veranstalter
Konferenztechnik	<ul style="list-style-type: none"> hochwertige Lautsprecher für gute Sprachverständlichkeit an jedem Platz bauseitig vorhanden (keine Zuspelgeräte und Mikrofone beinhaltet), Nutzung der bauseitig vorhandenen Projektorenhalterung und Signalanbindungen inkl. Stromanschluss möglich
Raumklima	<ul style="list-style-type: none"> Be- und Entlüftungsanlage als Teilklimaanlage zum Heizen und Kühlen
Beleuchtung	<ul style="list-style-type: none"> dimmbare Beleuchtung im Auditorium, einzel dimmbare Beleuchtung des Bühnenbereichs
Leinwand	<ul style="list-style-type: none"> Maße 3,0 m x 3,0 m
Verdunklung	<ul style="list-style-type: none"> komplette Verdunkelung möglich elektronischer Vorhang
Sanitäre Anlagen	<ul style="list-style-type: none"> WC-Anlage im Foyer mit separatem Behinderten-WC

MOC Veranstaltungszentrum München

KONFERENZRAUM

K1 UND K2

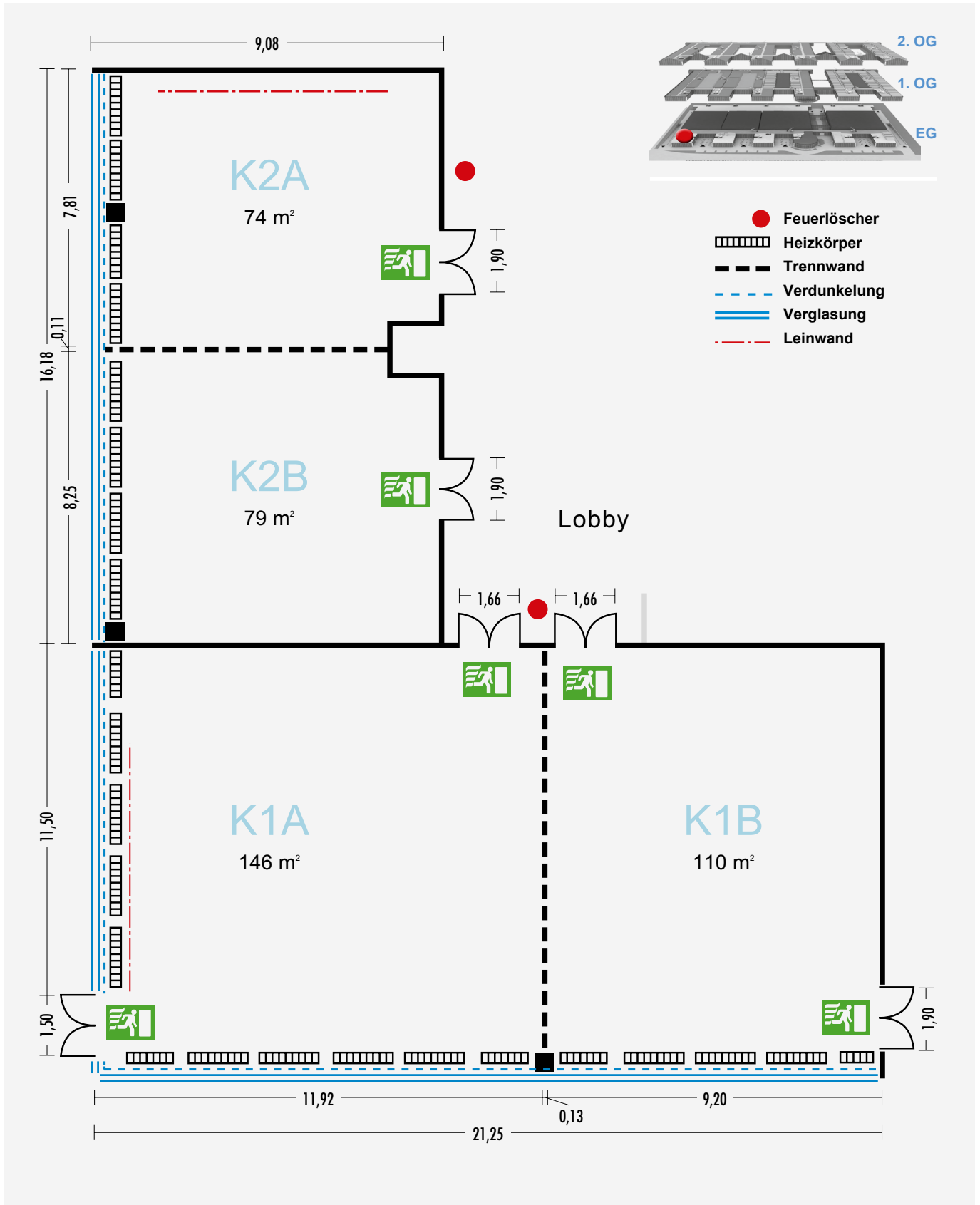





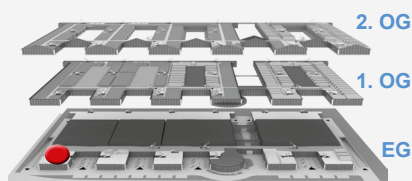
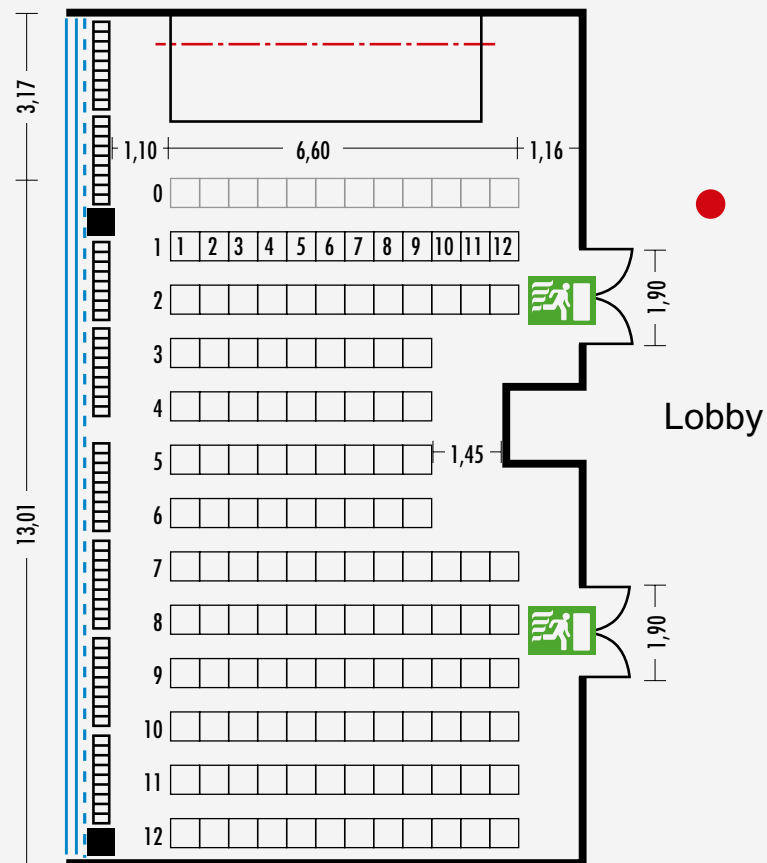

MOC Veranstaltungszentrum München

KONFERENZRAUM K2: REIHENBESTUHLUNG

Flächen/Räume	Fläche in m ²	 Reihe	 Parlament	 Bankett
K2*	153	144	74	52

*Raum teilbar

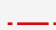

-  Feuerlöscher
-  Heizkörper
-  Trennwand
-  Verdunkelung
-  Verglasung
-  Leinwand





MOC Veranstaltungszentrum München

KONFERENZRAUM K2: PARLAMENTARISCHE BESTUHLUNG

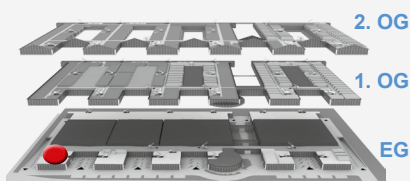
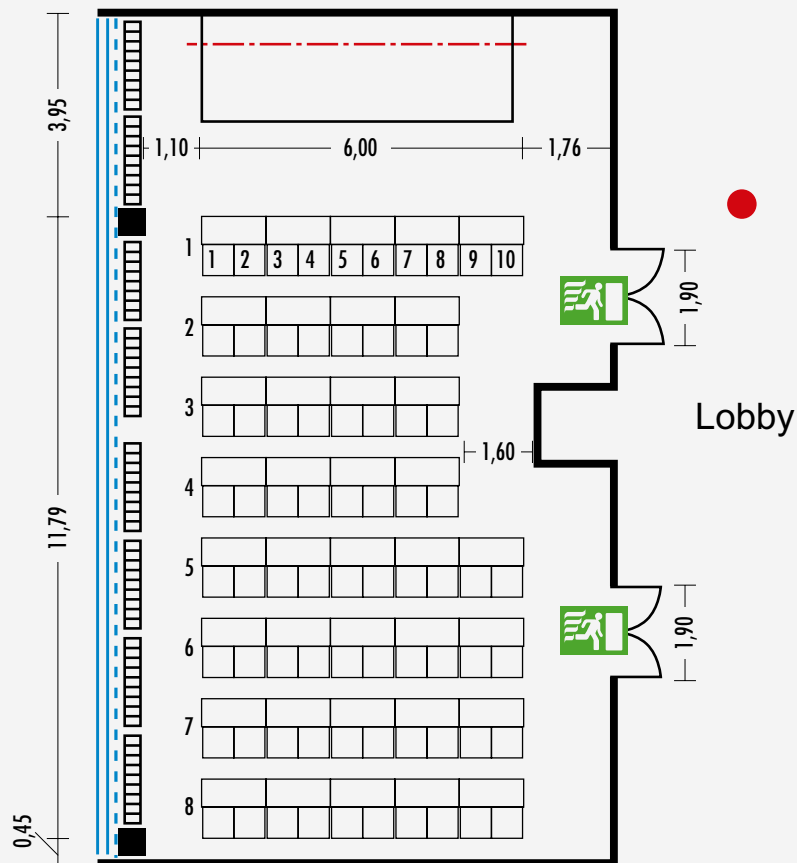
Flächen/Räume	Fläche in m ²	 Reihe	 Parlament	 Bankett
K2*	153	144	74	52

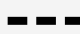

*Raum teilbar

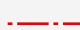





-  Feuerlöscher
-  Heizkörper
-  Trennwand
-  Verdunkelung
-  Verglasung
-  Leinwand

MOC Veranstaltungszentrum München

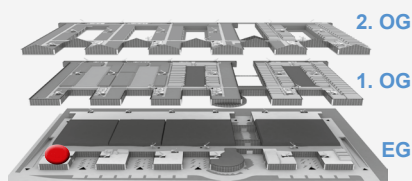
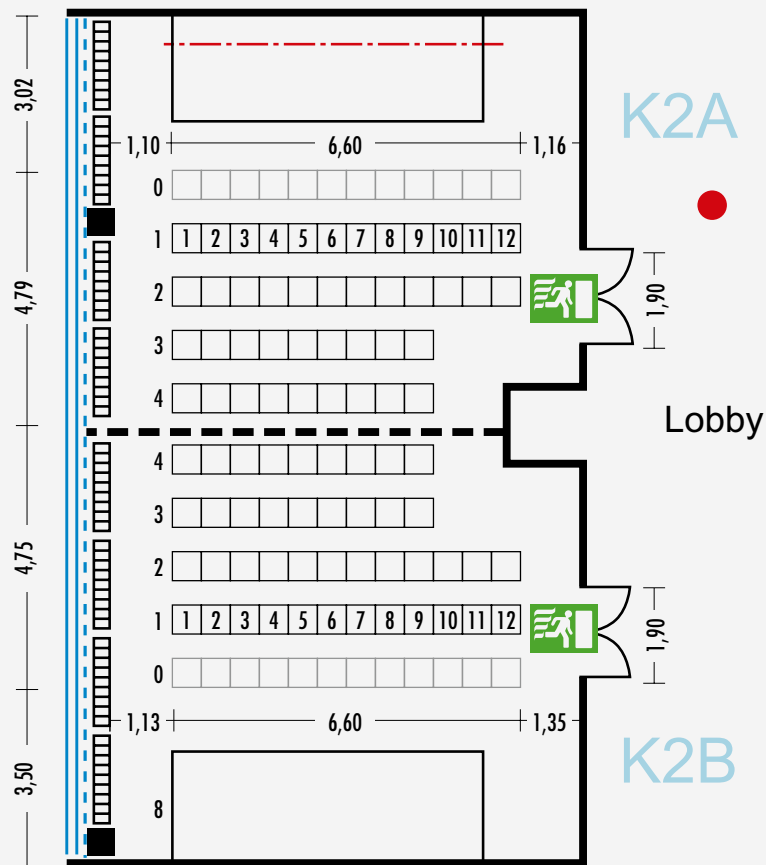
KONFERENZRAUM K2A UND K2B: REIHENBESTUHLUNG



Flächen/Räume	Fläche in m ²	 Reihe	 Parlament	 Bankett
K2A	74	54	28	24
K2B	79	54	28	28

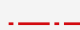





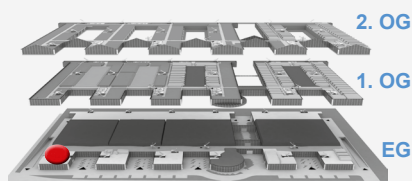
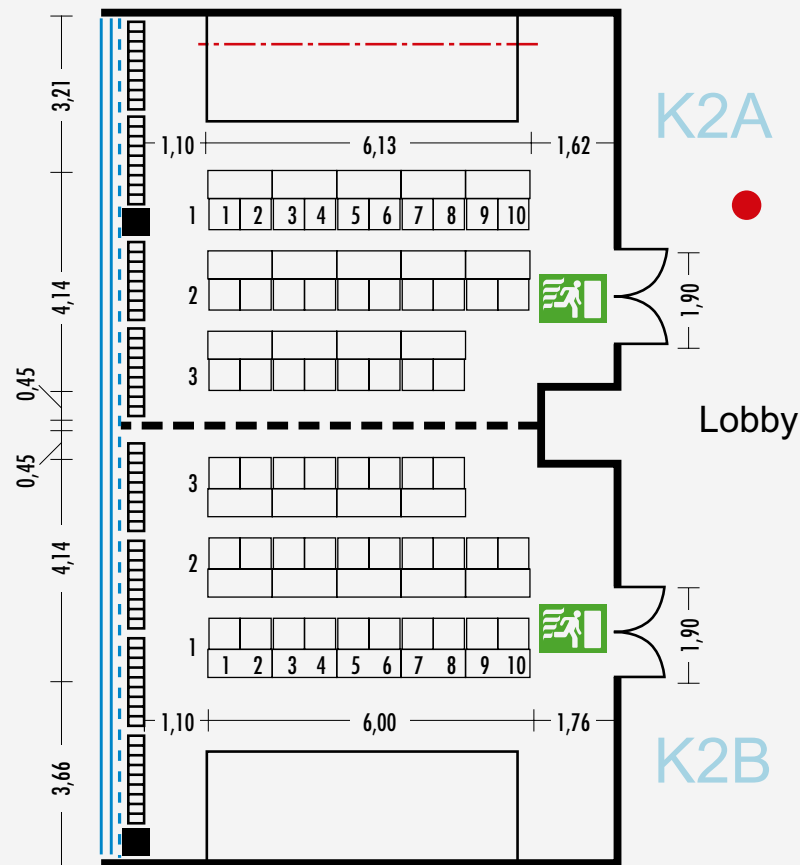

-  Feuerlöscher
-  Heizkörper
-  Trennwand
-  Verdunkelung
-  Verglasung
-  Leinwand

MOC Veranstaltungszentrum München

KONFERENZRAUM K2A UND K2B: PARLAMENTARISCHE BESTUHLUNG

Flächen/Räume	Fläche in m ²	 Reihe	 Parlament	 Bankett
K2A	74	54	28	24
K2B	79	54	28	28

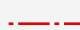

-  Feuerlöscher
-  Heizkörper
-  Trennwand
-  Verdunkelung
-  Verglasung
-  Leinwand